

# Position Reference Tab Replacement Instructions

Replacement Kit part # 96834

---



## Step 1

- Move the door in the "closed" position.

## Step 2

- Disconnect the operator from power.

## Step 3

- To find the reference position tab location face towards the garage door while under the rail.

## Step 4

- Measure and mark tab location (approximately 35"-38") from the motor shaft.

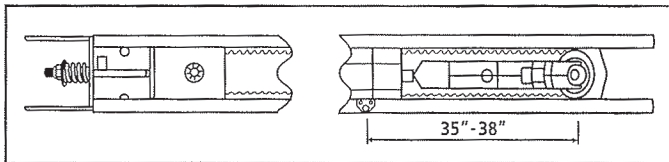

## Step 5

- Attach the two clips to the belt (A), slide the position tab (B) and install the rivet (C).

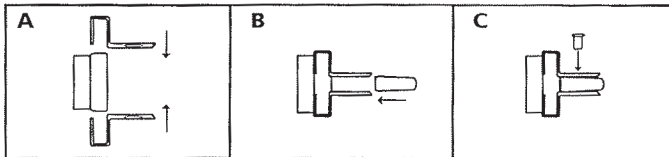

## Step 6

- With adjustable pliers crimp the rivet.

## Step 7

- Connect the operator to power.

## Step 8

- Reset "open" and "closed" door position as described in the owner's manual.

**For more information, please visit [www.devancocanada.com](http://www.devancocanada.com)  
or call toll free at 855-931-3334**

***HOW TO ORDER  
REPAIR PARTS***

**DEVANCO CANADA**

19192 HAY ROAD, UNIT Q  
SUMMERSTOWN, ON K0C 2E0

TOLL FREE: 855-931-3334

[www.devancocanada.com](http://www.devancocanada.com)

**WHEN ORDERING REPAIR PARTS  
PLEASE SUPPLY THE  
FOLLOWING INFORMATION:**

- ✓ PART NUMBER
- ✓ DESCRIPTION
- ✓ MODEL NUMBER